

SD Ground Terminal



Merkmale

- Masse- / Erdungsanschlüsse für Leiterplatten
- für SMT-Bestückung
- Materialstärke: 0,3 mm
- Material: Kupfer verzinnt

Abmessungen ► Einheit = mm

SD00405

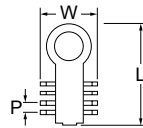

SD01138

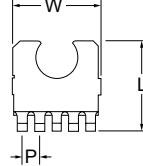

SD00433

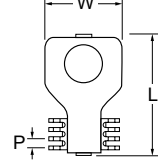

SD01218

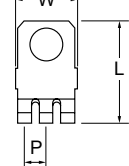

SD01228 | SD01255

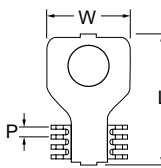

SD01294

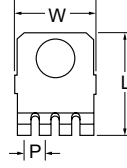

SD01387

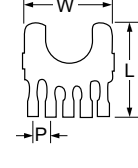

SD01388

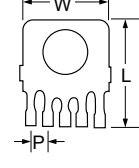

SD01480

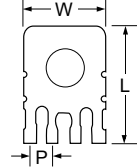

Art.-Nr.	Typ	L (mm)	W (mm)	P (mm)	Loch-Ø (mm)	für Schraube	Rollengröße (Stck.)
611 05 00	SD00405	10,7	6,0	1,0	3,0	M2,6	2.000
611 05 01	SD01138	8,5	8,3	1,6	4,0	M3	2.000
611 05 02	SD00433	12,7	8,0	1,0	4,0	M3	2.000
611 05 03	SD01218	7,5	4,5	1,6	2,4	M2	3.000
611 05 04	SD01228	12,7	8,0	1,0	4,5	M4	2.000
611 05 05	SD01255	12,7	8,0	1,0	4,4	M3	2.000
611 05 06	SD01294	8,0	6,3	1,6	3,0	M2,6	2.000
611 05 07	SD01387	8,5	8,0	1,6	4,2	M3	3.000
611 05 08	SD01388	10,0	8,0	1,6	4,2	M3	3.000
611 05 09	SD01480	10,0	7,0	1,9	3,2	M3	3.000

Merkmale

- Masse- / Erdungsanschlüsse für Leiterplatten
- für SMT-Bestückung
- Materialstärke: siehe Tabelle
- Material: Messing verzinnt

Abmessungen

► Einheit = mm

SD01506

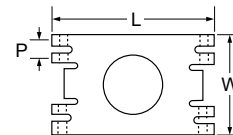

SD01688

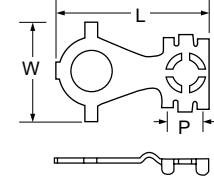

Art.-Nr.	Typ	L (mm)	W (mm)	P (mm)	Materialstärke (mm)	Loch-Ø (mm)	für Schraube	Rollengröße (Stck.)
611 05 10	SD01506	15,0	9,0	1,6	0,3	5,6	M4	1.500
611 05 11	SD01688	19,5	12,5	4,5	0,5	5,2	M4	1.000