

TR Ferrit-Ringkerne (NiZn)

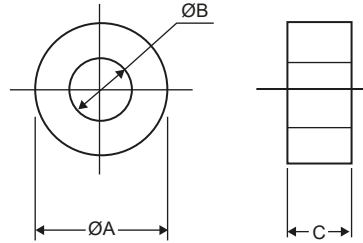

Abmessungen
► Einheit = mm



Art.-Nr.	Typ	A (mm)	B (mm)	C (mm)	Material	Impedanz Ω	
						25 MHz	100 MHz
600 05 070	TR-7,52-2,39-7,54-T2	7,52	2,39	7,54	T2	70	145
600 05 071	TR-7,62-3,18-4,78-T1	7,62	3,18	4,78	T2	25	50
600 05 07	TR-7,3-3,3-4,3-T1	7,3	3,3	4,3	T1	30	48
600 05 08	TR-8-4-4	8,0	4,0	4,0	T2	20	45
600 05 09	TR-9-4,9-8-T1	9,0	4,9	8,0	T1	38	64
600 05 091	TR-9-5-3-T1	9,0	5,0	3,0	T1	16	45
600 05 10	TR-10-5-5-T1	10,0	5,0	5,0	T1	55	98
600 05 11	TR-11-5-9-T1	11,0	5,0	9,0	T1	60	107
600 05 093	TR-9,65-5-4,83-T2	9,65	5,0	4,8	T2	10	30
600 05 092	TR-9,5-5,1-10-T1	9,5	5,1	10,0	T1	48	74
600 05 100	TR-10-6-6,2-T1	10,0	6,0	6,2	T1	25	49
600 05 01	TR-12-6-4-T1	12,0	6,0	4,0	T1	26	45
600 05 131	TR-13-7-5-T1	13,0	7,0	5,0	T3	33	62
600 05 13	TR-13-7-12,7-T1	13,0	7,0	12,7	T1	60	106
600 05 02	TR-14-5-5-9-T1	14,0	5,5	9,0	T1	20	65
600 05 06	TR-13-7,1-6,3-T2	13,0	7,1	6,3	T2	31	43
600 05 133	TR-12,7-7,9-12,7-T1	12,8	7,9	12,7	T3	50	95
600 05 124	TR-12,7-7,9-6,35-T1	12,7	7,9	6,35	T3	39	68
600 05 12	TR-12,5-8-12-T1	12,5	8,0	12,0	T1	42	72
600 05 141	TR-14-8-7-T1	14,0	8,0	7,0	T2	28	50
600 05 160	TR-16-8-13-T1	16,0	8,0	13,0	T3	64	118
600 05 17	TR-16-8,2-16-T1	16,3	8,2	16,0	T1	83	140
600 05 16	TR-16,3-8,2-13-T1	16,3	8,2	13,0	T1	70	125
600 05 175	TR-17,5-9,5-12,7-T1	17,5	9,5	12,7	T1	69	167
600 05 05	TR-16-10-7-T1	16,0	10,0	7,0	T1	29	41
600 05 04	TR-16-10-10-T1	16,0	10,0	10,0	T1	43	85
600 05 19	TR-16-10-14-T1	16,0	10,0	14,0	T1	53	85
600 05 18	TR-18-10-6-T1	18,0	10,0	6,0	T1	36	66
600 05 182	TR-18-10-10-T1	18,0	10,0	10,0	T3	30	80
600 05 14	TR-14,5-10,2-8-T1	14,5	10,2	8,0	T1	36	91
600 05 20	TR-20,4-10,2-5-T1	20,4	10,2	5,0	T1	29	43
600 05 21	TR-20,5-10,2-10-T1	20,5	10,25	10,0	T1	53	86
600 05 15	TR-17,5-10,7-18-T1	17,5	10,7	18,0	T1	70	110
600 05 23	TR-23-11-14-T1	23,0	11,0	14,0	T1	80	133
600 05 161	TR-16-12-8-T1	16,0	12,0	8,0	T3	74	99
600 05 24	TR-21,2-12,7-6-T1	21,2	12,7	6,0	T1	38	126
600 05 22	TR-22-14-8-T1	22,0	14,0	8,0	T3	30	60
600 05 250	TR-25-15-5-T2	25,0	15,0	5,0	T2	15	45
600 05 25	TR-25-15-12-T1	25,0	15,0	12,0	T1	54	102
600 05 28	TR-28-16-13-T1	28,0	16,0	13,0	T3	58	114
600 05 29	TR-28-16-20-T1	28,0	16,0	20,0	T3	81	125
600 05 32	TR-31-19-16-T1	31,0	19,0	16,0	T1	78	163
600 05 311	TR-31,7-19-13-T1	31,7	19,0	13,0	T3	64	132
600 05 31	TR-31-19-8-T1	31,0	19,0	8,0	T1	34	60
600 05 37	TR-35,6-23-12,7-T1	35,6	23,0	12,7	T3	25	90
600 05 36	TR-36-23-15-T1	36,0	23,0	15,0	T1	39	112
600 05 38	TR-35,6-25,4-7,5-T1	35,6	25,4	7,5	T3	34	114
600 05 40	TR-40,6-27,2-15-T1	40,6	27,2	15,0	T1	55	98
600 05 46	TR-46-31-12	46,0	31,0	12,0	T1	53	108
600 05 61	TR-61,4-36-12,8-T1	61,4	36,0	12,8	T1	58	104

Andere Abmessungen und Materialien auf Anfrage, Tel.: 09852 61079-0