

BPE-SC LWL-Blindlochabdeckung



Merkmale

- LWL-Blindlochabdeckung
- Material: Nylon 6/6, RMS-01
- Farbe: schwarz

Abmessungen

► Einheit = mm

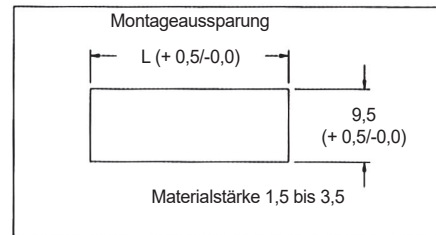
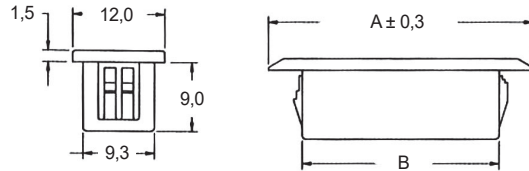

Art.-Nr.	Typ	A (mm)	B (mm)	L (mm)
242 02 11	BPE-SC-1-01	21,5	12,8	13,0
242 02 12	BPE-SC-2-01	16,0	12,8	13,0
242 02 13	BPE-SC-3-01	34,7	25,8	26,0