

DIN7985 Linsenkopfschrauben



Merkmale

- mit Kreuzschlitz ähnlich DIN7985
- Material: Polyamid 6.6
- Farbe: natur

Abmessungen

► Einheit = mm

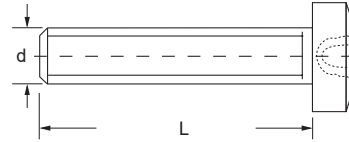

Art.-Nr.	d (mm)	L (mm)
140 02 04 PA	M2	4,0
140 02 05 PA	M2	5,0
140 02 06 PA	M2	6,0
140 02 08 PA	M2	8,0
140 02 10 PA	M2	10,0
140 02 12 PA	M2	12,0
140 02 16 PA	M2	16,0
140 02 20 PA	M2	20,0
140 02 25 PA	M2	25,0
140 01 04 PA	M2,5	4,0
140 01 05 PA	M2,5	5,0
140 01 06 PA	M2,5	6,0
140 01 08 PA	M2,5	8,0
140 01 10 PA	M2,5	10,0
140 01 12 PA	M2,5	12,0
140 01 16 PA	M2,5	16,0
140 01 20 PA	M2,5	20,0
140 01 25 PA	M2,5	25,0
140 03 05 PA	M3	5,0
140 03 06 PA	M3	6,0
140 03 08 PA	M3	8,0
140 03 10 PA	M3	10,0
140 03 12 PA	M3	12,0
140 03 16 PA	M3	16,0
140 03 20 PA	M3	20,0
140 03 25 PA	M3	25,0
140 03 30 PA	M3	30,0
140 03 35 PA	M3	35,0
140 03 40 PA	M3	40,0
140 03 45 PA	M3	45,0
140 04 05 PA	M4	5,0
140 04 06 PA	M4	6,0
140 04 08 PA	M4	8,0
140 04 10 PA	M4	10,0
140 04 12 PA	M4	12,0
140 04 16 PA	M4	16,0
140 04 20 PA	M4	20,0
140 04 25 PA	M4	25,0
140 04 30 PA	M4	30,0
140 04 35 PA	M4	35,0
140 04 40 PA	M4	40,0
140 04 45 PA	M4	45,0

Art.-Nr.	d (mm)	L (mm)
140 04 50 PA	M4	50,0
140 04 55 PA	M4	55,0
140 04 60 PA	M4	60,0
140 05 06 PA	M5	6,0
140 05 08 PA	M5	8,0
140 05 10 PA	M5	10,0
140 05 12 PA	M5	12,0
140 05 16 PA	M5	16,0
140 05 20 PA	M5	20,0
140 05 25 PA	M5	25,0
140 05 30 PA	M5	30,0
140 05 35 PA	M5	35,0
140 05 40 PA	M5	40,0
140 05 45 PA	M5	45,0
140 05 50 PA	M5	50,0
140 05 60 PA	M5	60,0
140 05 70 PA	M5	70,0
140 06 06 PA	M6	6,0
140 06 08 PA	M6	8,0
140 06 10 PA	M6	10,0
140 06 12 PA	M6	12,0
140 06 16 PA	M6	16,0
140 06 20 PA	M6	20,0
140 06 25 PA	M6	25,0
140 06 30 PA	M6	30,0
140 06 35 PA	M6	35,0
140 06 40 PA	M6	40,0
140 06 45 PA	M6	45,0
140 06 50 PA	M6	50,0
140 06 60 PA	M6	60,0
140 06 70 PA	M6	70,0
140 06 75 PA	M6	75,0
140 06 80 PA	M6	80,0
140 06 85 PA	M6	85,0
140 06 90 PA	M6	90,0
140 06 95 PA	M6	95,0
140 06 100 PA	M6	100,0
140 06 110 PA	M6	110,0
140 06 120 PA	M6	120,0
140 06 130 PA	M6	130,0

Weitere Abmessungen und andere Materialien auf Anfrage, Tel.: 09852 61079-0