

AB-IA-M2 - SW4 Abstandsbolzen



Merkmale

- 6-kant Abstandsbolzen mit M2 Innen-/ Außengewinde
- Schlüsselweite (SW) 4
- Material: Nylon 6.6
- Farbe: natur (UL94 V-2), schwarz (UL94 V-0)

Abmessungen ► Einheit = mm

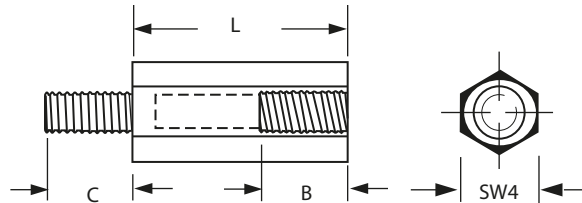

Art.-Nr.	L (mm)	B (mm)	C (mm)
100 84 05	5,0	3,0	5,0
100 84 05 S	5,0	3,0	5,0
100 84 55	5,5	3,0	5,0
100 84 06	6,0	4,0	5,0
100 84 65	6,5	4,0	5,0
100 84 65 S	6,5	4,0	5,0
100 84 07	7,0	4,0	5,0
100 84 08	8,0	5,0	5,0
100 84 08 S	8,0	5,0	5,0
100 84 09	9,0	5,0	5,0
100 84 10	10,0	5,0	5,0
100 84 10 S	10,0	5,0	5,0
100 84 11	11,0	5,0	5,0
100 84 12	12,0	5,0	5,0
100 84 13	13,0	5,0	5,0
100 84 14	14,0	5,0	5,0

Art.-Nr.	L (mm)	B (mm)	C (mm)
100 84 15	15,0	5,0	5,0
100 84 15 S	15,0	5,0	5,0
100 84 16	16,0	5,0	5,0
100 84 17	17,0	5,0	5,0
100 84 18	18,0	5,0	5,0
100 84 19	19,0	5,0	5,0
100 84 20	20,0	5,0	5,0
100 84 21	21,0	5,0	5,0
100 84 22	22,0	5,0	5,0
100 84 23	23,0	5,0	5,0
100 84 24	24,0	5,0	5,0
100 84 25	25,0	5,0	5,0
100 84 26	26,0	5,0	5,0
100 84 27	27,0	5,0	5,0
100 84 28	28,0	5,0	5,0

Weitere Abmessungen und Größen auf Anfrage, Tel.: 09852 61079-0